

July 20 2009

SPECIAL MEETING NOTICE - Friday Aug 7th 2009 9:15 PM after Program

In accordance with By-Law 8 Section 5: (14 days notice of general meeting), notice is given for a special meeting to take place at the Imambara of Anjuman-e-Asghari Islamic Center at approximately 9:15 PM after the program to:

Gain Approval from the General Body for annexation & improvement of adjacent land

To be completed before the end of November 2009 (ground freeze)

Issue:

- The land south of the parking lot (past the fence) belongs to the Jamaat ((255'+285')X70' OR 18,900 sq. ft OR 0.43 acres) - see attached map
- It has not been used/claimed by the community since the purchase of the land 20 years ago
- The community may lose it to the City or Government if not reclaimed/alterd now
- Required by the City to claim and utilize if community would like to keep the land

Options:

- Do nothing at this time and run the risk of losing the land to the City
- Retain the land by altering it by clearing the trees and grass land and re-fencing it to the edge of the trail to identify the Jamaat's property

Advantages of Retaining the Land:

- Retain valuable land for sale to City/Buyer in the future for more than the investment
- Excess parking for cars during heavily attended programs (no double or church parking)
- Use the land for kids activity or any other general purpose

Projected Cost: \$20,000.00

Projected Cost Includes:

- Partially removing the existing fence
- Clearing the land beyond the fence of trees, grass, and debris
- Installing a new fence to identify the land/property

NEXT STEPS:

Step 1: Gain approval from the general body to alter the land and reclaim it

Step 2: If approved, file the necessary documents with the City to show the Jamaat's intent

Step 3: If approved, do a fund raiser to pay for the project

Step 4: Complete the project prior to ground freeze

| PLANT SCHEDULE | | | | |
|----------------|------------------------|-------------------|----------|-----------|
| NO. | BOTANICAL NAME | COMMON NAME | QUANTITY | SIZE |
| 1 | Fraxinus Penn leuca | Marshall's Ash | 3 | 2 1/2" DB |
| 2 | Picea Prostrata Glauca | Cold green Spruce | 3 | 4" DB |
| 3 | Malva Spring Snow | Spring Snow Crab | 3 | 1 1/2" DB |
| 4 | Malva Red Splendor | Red Splendor Crab | 1 | 1 1/2" DB |
| 5 | Aspidistra Chlorostoma | Mist July Judger | 7 | 3 gal |

PREVIOUSLY APPROVED LANDSCAPING FOR RESOLVE AND THE LEASING CENTER LOT INDICATED.

Anjuman-e-Asghari Site Plan

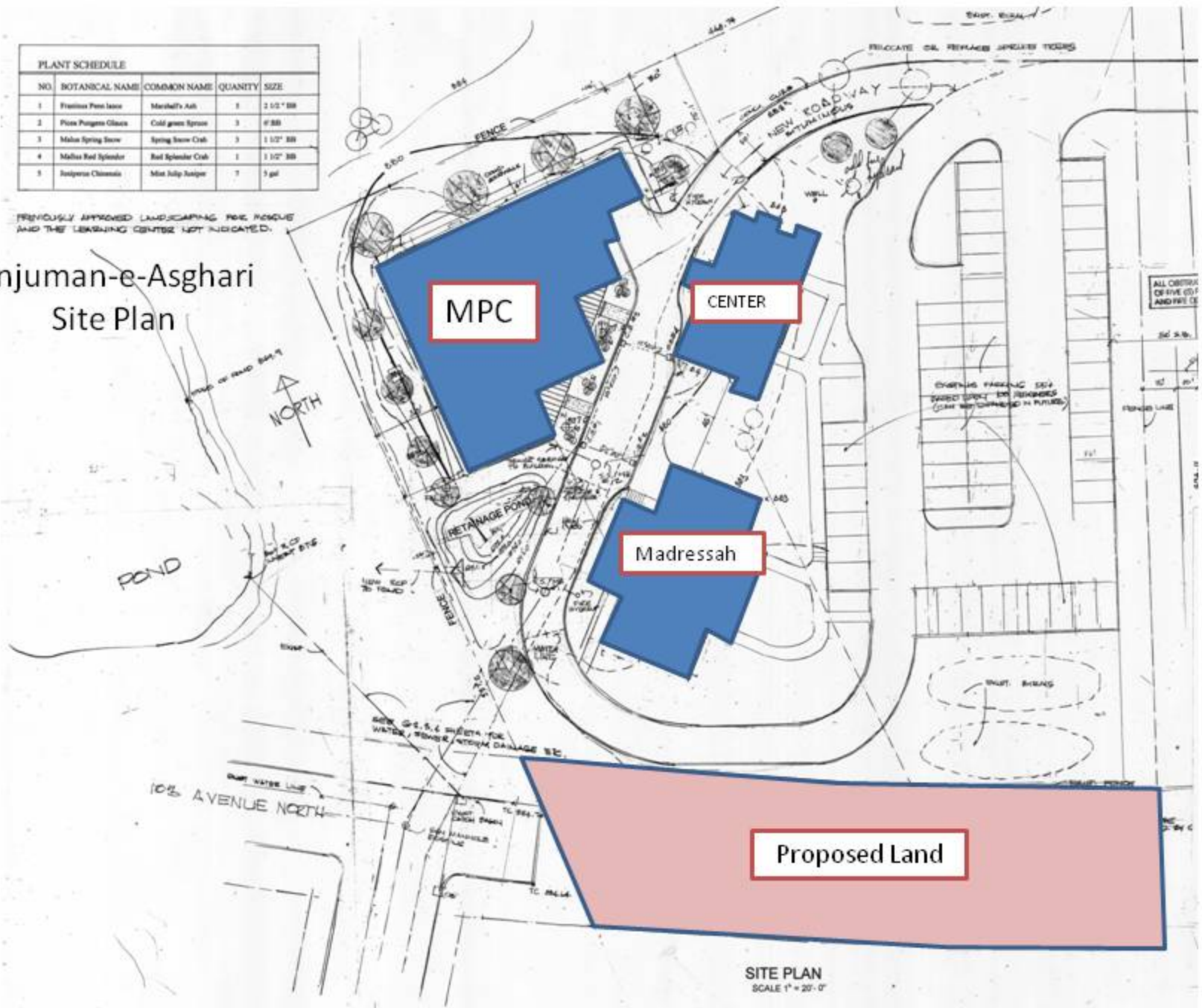

SITE PLAN
SCALE 1" = 20'-0"